

### Specification

Nominal Voltage	12V	
Watts(15min Rate)	356.1 Watte at 1.67V/cell	
Dimension	Length	330 ± 3mm (13.0 inches)
	Width	173 ± 2mm (6.81 inches)
	Container Height	212 ± 3mm (8.35 inches)
	Total Height (with Terminal)	220 ± 3mm (8.66 inches)
Approx Weight	Approx 30.6 kg (67.5lbs)	
Terminal	T11	
Container Material	ABS	
Rated Capacity	104.0 AH/10.4A	(10hr, 1.80V/cell, 25°C/77°F)
	100.0 AH/12.5A	(8hr, 1.80V/cell, 25°C/77°F)
	89.5 AH/17.9A	(5hr, 1.75V/cell, 25°C/77°F)
	78.8 AH/26.6A	(3hr, 1.75V/cell, 25°C/77°F)
	68.2 AH/68.2A	(1hr, 1.60V/cell, 25°C/77°F)
Max. Discharge Current	1200A (5s)	
Internal Resistance	Approx 4.9mΩ	
Operating Temp. Range	Discharge	-15 ~ 50°C (5 ~ 122°F)
	Charge	0 ~ 40°C (32 ~ 104°F)
	Storage	-15 ~ 40°C (5 ~ 104°F)
Nominal Operating Temp. Range	25 ± 3°C (77 ± 5°F)	
Cycle Use	Initial Charging Current less than 30.0A. Voltage	
	14.4V~15.0V at 25°C(77°F)Temp. Coefficient -30mV/°C	
Standby Use	No limit on Initial Charging Current Voltage	
	13.5V~13.8V at 25°C(77°F)Temp. Coefficient -20mV/°C	
Capacity affected by Temperature	40°C (104°F)	103%
	25°C (77°F)	100%
	0°C (32°F)	86%
Self Discharge	Leoch LPX series batteries may be stored for up to 6 months at 25°C(77°F) and then a freshening charge is required. For higher temperatures the time interval will be shorter.	



### Applications

- ◆ UPS (High rate)
- ◆ High power backup supply
- ◆ Emergency power supply
- ◆ Starting system
- ◆ Power tools
- ◆ Emergency lighting
- ◆ Electric starting



### Constant Current Discharge (Amperes) at 25 °C (77°F)

F.V/Time	5min	10min	15min	20min	30min	45min	1h	2h	3h	4h	5h	6h	8h	10h	20h
1.85V/cell	193.2	156.0	138.8	118.5	89.2	67.9	56.9	33.4	24.3	19.5	16.5	14.6	12.0	10.00	5.16
1.80V/cell	235.1	185.1	155.2	128.4	95.8	71.7	60.4	35.6	25.8	20.6	17.5	15.4	12.5	10.4	5.34
1.75V/cell	272.4	204.3	168.0	136.8	99.8	75.3	62.0	36.5	26.6	21.1	17.9	15.7	12.7	10.5	5.39
1.70V/cell	302.6	216.5	179.6	142.8	102.8	78.1	64.0	37.1	27.0	21.5	18.2	15.8	12.7	10.6	5.44
1.67V/cell	318.9	231.0	189.4	149.1	106.4	80.5	66.0	37.9	27.4	22.0	18.5	16.1	12.9	10.7	5.49
1.60V/cell	341.6	244.0	198.8	156.0	110.6	82.3	68.2	38.5	27.9	22.3	18.8	16.3	13.0	10.8	5.54

### Constant Power Discharge (Watts/cell) at 25 °C (77°F)

F.V/Time	5min	10min	15min	20min	30min	45min	1h	2h	3h	4h	5h	6h	8h	10h	20h
1.85V/cell	364.4	295.6	268.3	230.8	174.9	133.9	112.8	66.4	48.6	39.1	33.2	29.4	24.2	20.3	10.5
1.80V/cell	439.5	348.1	298.1	248.7	187.0	140.8	119.2	70.5	51.4	41.3	35.0	30.9	25.2	21.0	10.8
1.75V/cell	504.4	381.4	320.7	263.8	194.0	147.4	122.1	72.1	52.7	42.0	35.7	31.3	25.4	21.1	10.9
1.70V/cell	555.3	401.0	340.7	273.9	199.0	152.4	125.6	73.2	53.5	42.7	36.3	31.6	25.5	21.2	10.9
1.67V/cell	579.2	423.7	356.1	283.9	204.8	156.4	129.0	74.4	54.0	43.5	36.8	32.1	25.7	21.4	11.0
1.60V/cell	612.4	442.9	370.6	294.5	211.2	158.8	132.7	75.3	54.9	44.0	37.2	32.4	25.9	21.5	11.1

Specifications subject to change without notice.



## Dimensions

### T11 Terminal

Unit: mm [inches]

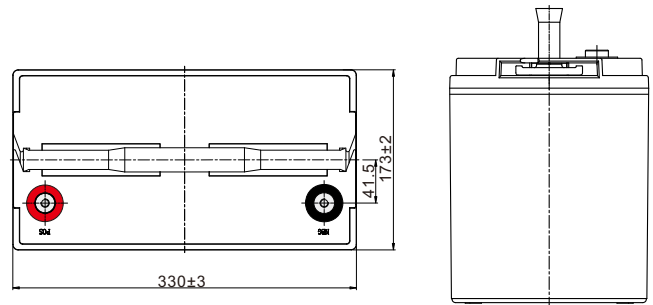
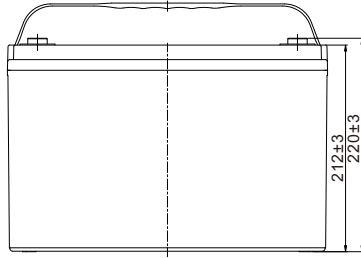
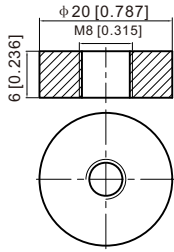

## Discharge Characteristics

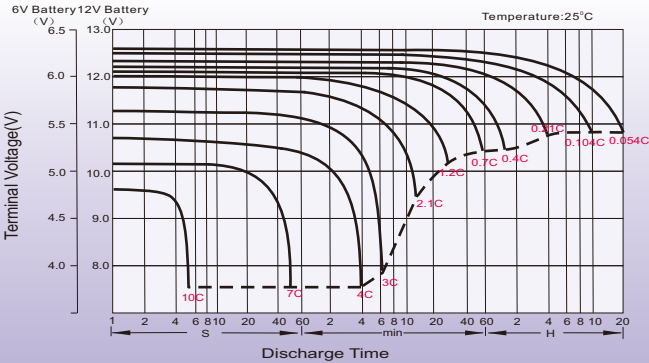

## Float Charging Characteristics

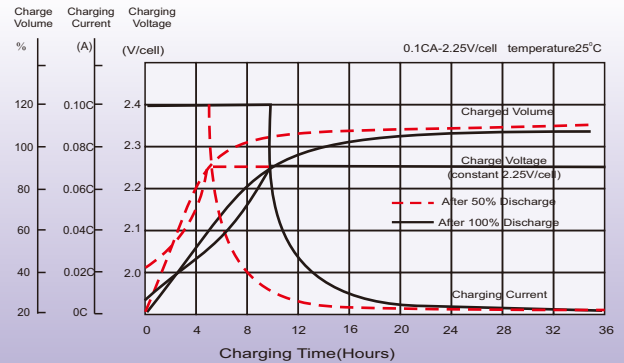

## Temperature Effects in Relation to Battery Capacity

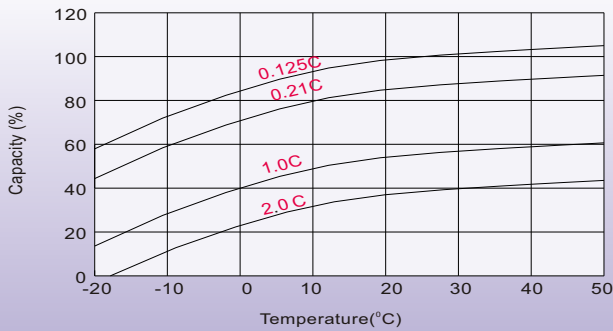

## Effect of Temperature on Long Term Float Life

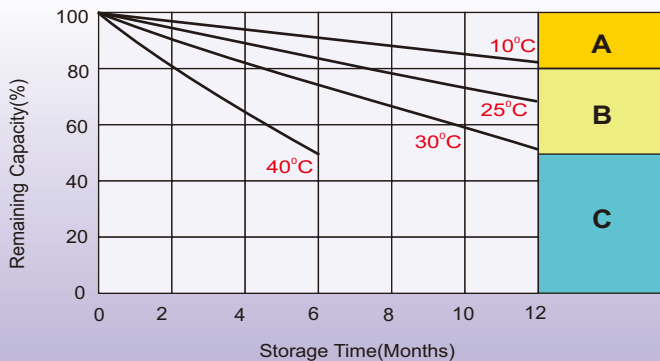
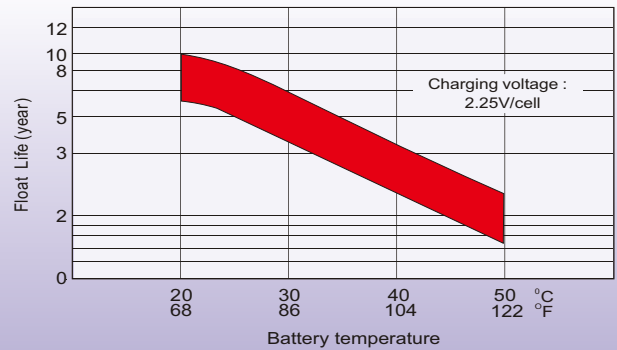

## Self Discharge Characteristics

- A** No supplementary charge required  
(Carry out supplementary charge before use if 100% capacity is required.)
- B** Supplementary charge required before use. Optional charging way as below:
  1. Charged for above 3 days at limited current 0.25CA and constant volatge 2.25V/cell.
  2. Charged for above 20hours at limited current 0.25CA and constant volatge 2.45V/cell.
  3. Charged for 8-10hours at limited current 0.05CA .
- C** Supplementary charge may often fail to recover the capacity.  
The battery should never be left standing till this is reached.

## Sales Office

### China sales office:

Add:5th Floor,Xinbaohui Bldg.,Nanhai Blvd.,  
Nanshan,Shenzhen, China. 518052  
Tel: +86-755-86036060 (100 lines)  
Fax: +86-755-26067269  
E-mail:export@leoch.com  
Http://www.leoch.com

### HongKong sales office:

Workshop C, 33/F, TML Tower,  
No. 3 Hoi Shing Road, Tsuen Wan,  
New Territories, Hong Kong  
Tel: +852 35786666  
Fax: +852 21170016  
E-mail: sales.hk@leoch.com

### Singapore sales office:

Add: No. 1 Tech Park Crescent,  
Singapore 638131  
Tel: +65 68636078  
Fax: +65 68636079  
Email sales.sg@leoch.com  
Http://www.leoch.com

### North America sales office:

Add: 19751 Descartes, Unit A,  
Foothill Ranch, CA 92610, USA  
Tel: 949-588-5853  
Fax: 949-588-5966  
E-mail: sales@leoch.us  
Http://www.leoch.us

### Europe sales office:

Add: 9B Wheatstone Court. Waterwells  
Business Park, Gloucester, GL2-2AQ,  
UK United Kingdom  
Tel: +44(0) 1452 729428 / 1452 729696  
Fax: +44 (0)1452-690125  
E-mail: Sales.Europe@leoch.com