

Physical Specification

Nominal Voltage	6V
Nominal Capacity(20HR)	390Ah
Nominal Capacity(5HR)	331Ah
Length	295±2mm(11.61inches)
Width	180±2mm(7.09inches)
Container Height	406±2mm(15.98inches)
Total Height	428±2mm(16.85inches)
Wet Weight	Approx54.2 Kg(119.5 lbs)
Standard Terminal	LPT-A
Container Material	PP

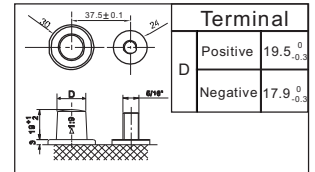
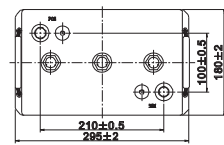
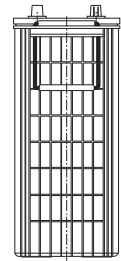
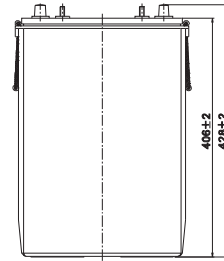

Charge Method
Constant voltage charging at 20°C (68°F)

Type	Standby use	Cyclic use
Max.Charge Current	0.25C ₁₀ A	0.25C ₁₀ A
Charge Voltage	6.8~6.9V	7.2~7.35V
Temperature Compensation	-10mV/°C	-15mV/°C

Electrical Specification(20°C , 68°F)

Rated Capacity	20hourrate(19.5A)	390Ah
	5hourrate(66.2A)	331Ah
Reserve Capacity	25Amps	915min
	75Amps	255min

Discharge Characteristics(20°C , 68°F)

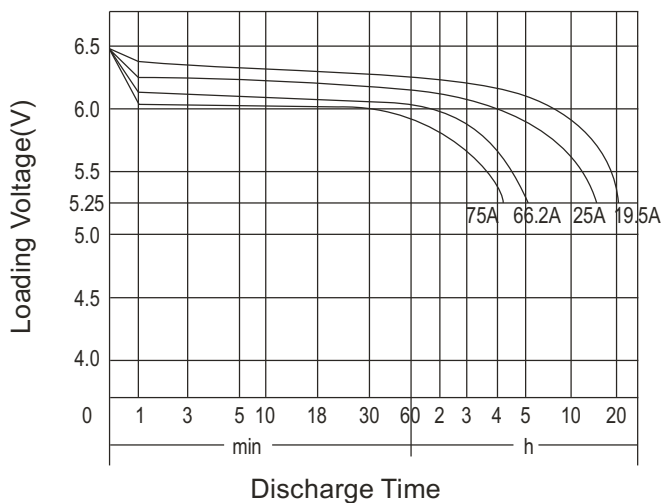

Cycle life in relation to depth of discharge

