



AGM CONCEPT GOLF CART BATTERY

Model: DTA12145(12V145AH)

Specification

Nominal Voltage		12V
Rated Capacity (25°C)	20 Hour Rate (7.25A to 10.50V)	145.0Ah
	10 Hour Rate (13.0A to 10.50V)	130.0Ah
	5 Hour Rate (24.4A to 10.50V)	122.0Ah
Reserve Capacity	@25A	279 Minutes
	@75A	86 Minutes
Dimensions	Length	340.5 mm(13.4 inches)
	Width	172.0 mm(6.77 inches)
	Height	280.0 mm(11.0 inches)
	Total Height	286.0 mm(11.3 inches)
Weight		41.5 kg (91.5 lbs)



Characteristics

Capacity Affected by Temperature (20 HR)			Self Discharge @ 25°C(77°F)	Max. Discharge Current@ 25°C(77°F)	Charging @ 25°C(77°F) (Constant Voltage)		Internal Resistance @ 25°C(77°F)	Container Material
0°C (32°F)	25°C (77°F)	40°C (104°F)			Cycle	Float		
85%	100%	102%	<3% of capacity per month	1450A(5S)	14.4~14.7V	13.6~13.8V	3.5mΩ	ABS

Typical Applications

- Golf cart
- Electric vehicle
- Solar
- Wheelchair
- Electric sightseeing car
- Electric scooter
- Electric forklift
- Scraper
- Marine
- Portable Medical device

Battery Structure and Size

T11 Terminal

Unit: mm

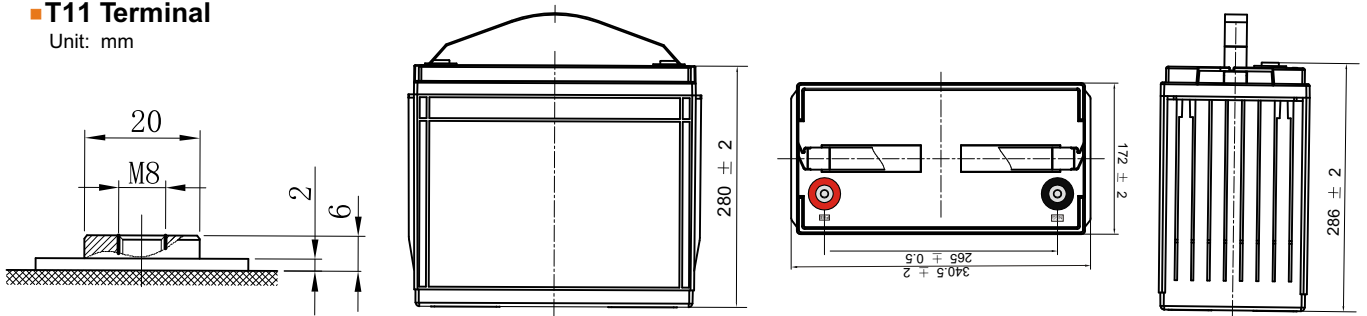

Key features & Benefits

- Maintenance-free sealed construction, spill proof-safe and reliable.
- Strength-enhanced ABS container and compressed plate groups-better vibration and impact resistant.
- Special Lead-Calcium grid design-better corrosion resistant, deep discharge performance, higher capacity and longer cycle life.
- High porosity AGM separator-high oxygen recombination rate to ensure minimum gassing.
- Brass insert terminals-superior conductivity and high rate discharge performance.
- Low internal resistance-high charge acceptance and quick recharge.
- Low self discharge-longer shelf life than conventional batteries.

Performance Characteristics

Constant voltage charging characteristic (0.15CA, 25°C, 77°F)

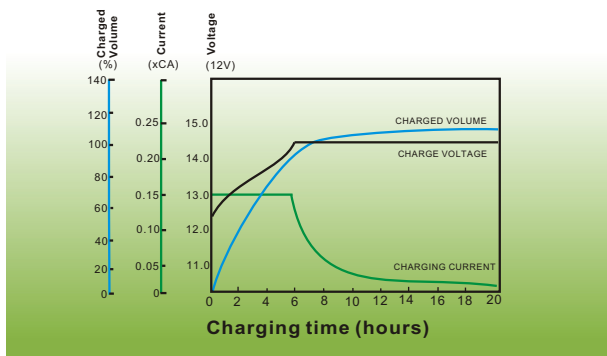

Cycle life in relation to depth of discharge

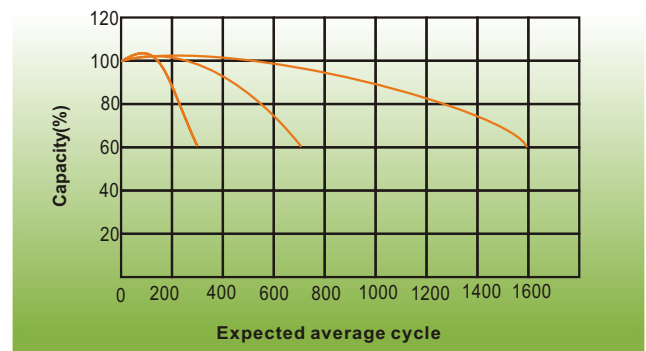

LEOCH INTERNATIONAL TECHNOLOGY LIMITED

Factory: Jiangsu · Zhaoqing · Anhui · Shenzhen · Dongguan

China sales office:

Add: 5th Floor, Xinbaohui Bldg., Nanhai Blvd.,
Nanshan, Shenzhen, China. 518052

Tel: +86 755-86036060 (100 lines)

Fax: +86-755-26067269

E-mail: export@leoch.com

Http://www.leoch.com

North America sales office:

Add: 19751 Descartes, Unit A,
Foothill Ranch, CA 92610, USA

Tel: 949-588-5853

Fax: 949-588-5966

E-mail: sales@leoch.us

Http://www.leoch.us

Europe sales office:

Add: 9B Wheatstone Park, Waterwells
Business Park, Gloucester, GL2 2AQ. UK.

Tel: +44(0) 01452 729428

Fax: +44 (0)1452-690125

E-mail: Sales.Europe@leoch.com

Singapore sales office:

Add: No. 53, Ubi Avenue 1, #03-21 Paya
Ubi Industrial Park, Singapore 408934

Tel: + 65 6841 6629

E-mail: sales.sg@leoch.com

HongKong sales office:

Add: Unit 3910, 39/F, Cable TV Tower, No. 9
Hoi Shing Road, Tsuen Wan, NT.H.K

Tel: +852 3578 6666

E-mail: sales.hk@leoch.com