

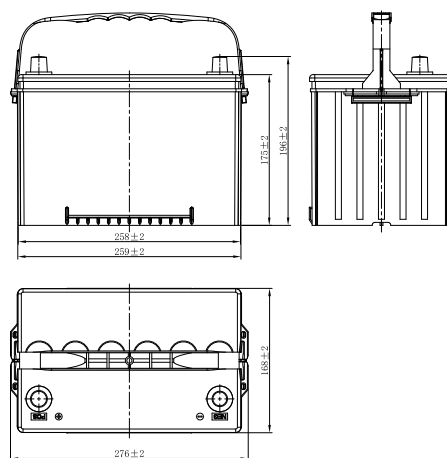

AGM34-55 [12V55Ah]



Dimensions (mm)



Physical Specification (mm)

Nominal Voltage		12V
Nominal Capacity(20HR)		55Ah
Dimension	Length	276±2mm(10.87inches)
	Width	168±2mm(6.61inches)
	Container Height	175±2mm(6.89inches)
	Total Height(with Terminal)	196±2mm(7.72inches)
Weight		Approx 19.1Kg(42.12lbs)
Standard Terminal		1
Cell layout		1
Hold-Down		B1
Cell plate qty		/
Case		Black-PP Material
Cover		Black-PP Material
Handle		Black-PP Material

Electrical Specification

Rated Capacity	20 hour rate(2.75A)	55Ah
Reserve Capacity	120min	
Cold Cranking Performance Amps@0°F(-18°C)	650A	

Standard Terminal (mm)

Terminal Type	D	
	Positive	Negative
1	19.5 ⁰ _{-0.3}	17.9 ⁰ _{-0.3}

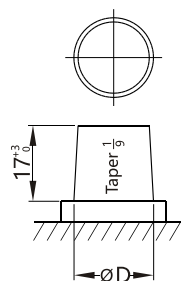

Cell Layout

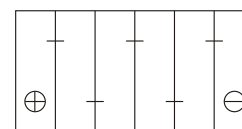

Figure(1)

Discharge Characteristics(-18°C,0°F)

AGM34-55(CCA-SAE)
 (CCA-SAE)Capacity Test(@-18)with I=650A
 Spec $U_{10S} \geq 7.5V$ $U_{30S} \geq 7.2V$

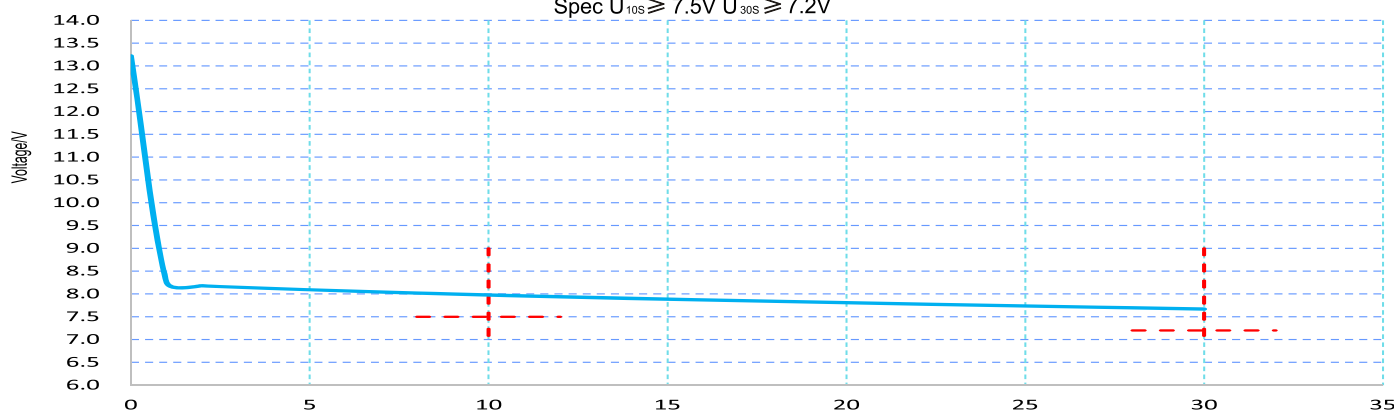

*Values are subject to variation of +/- 5% in normal manufacturing processes.
 *Technical specifications and the product line above could be changed without prior notice.