

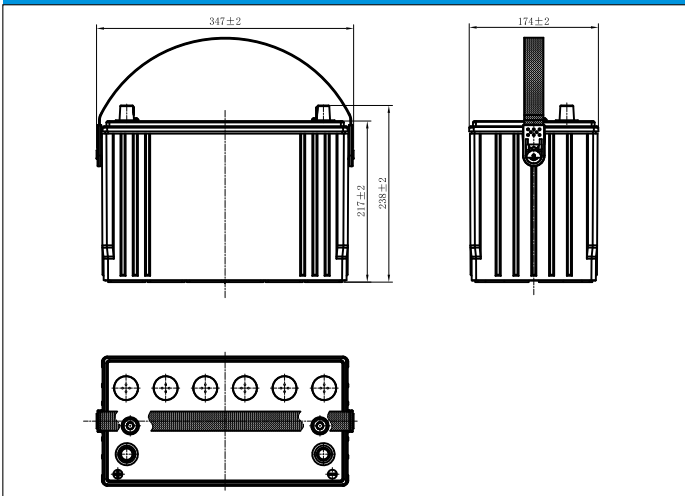

AGM31-100R-A (12V100Ah)



Dimensions (mm)



Physical Specification (mm)

| | | |
|------------------------|-----------------------------|-------------------------|
| Nominal Voltage | | 12V |
| Nominal Capacity(20HR) | | 100Ah |
| Dimension | Length | 347±2mm(13.66inches) |
| | Width | 174±2mm(6.85inches) |
| | Container Height | 217±2mm(8.54inches) |
| | Total Height(with Terminal) | 238±2mm(9.37inches) |
| Weight | | Approx 31.4Kg(69.24lbs) |
| Standard Terminal | | 12 |
| Cell layout | | 1 |
| Hold-Down | | B0 |
| Cell plate qty | | / |
| Case | | Black-PP Material |
| Cover | | Black-PP Material |
| Handle | | Black-PP Material |
| | | |
| | | |

Electrical Specification

| | | |
|---|--------------------|-------|
| Rated Capacity | 20 hour rate(5.0A) | 100Ah |
| Reserve Capacity | 190min | |
| Cold Cranking Performance Amps@0°F(-18°C) | 850A | |

Standard Terminal (mm)

| Terminal Type | D | |
|---------------|-----------------------------------|-----------------------------------|
| | Positive | Negative |
| 12 | 19.5 ⁰ _{-0.3} | 17.9 ⁰ _{-0.3} |

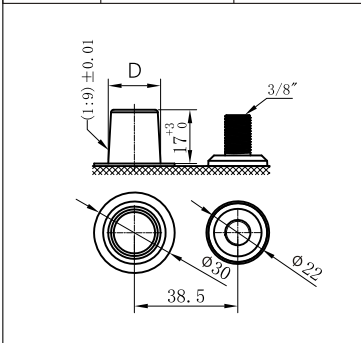

Cell Layout

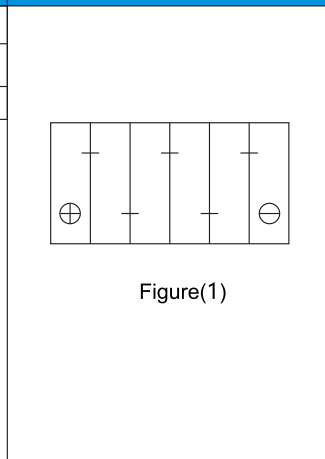

Discharge Characteristics(-18°C,0°F)

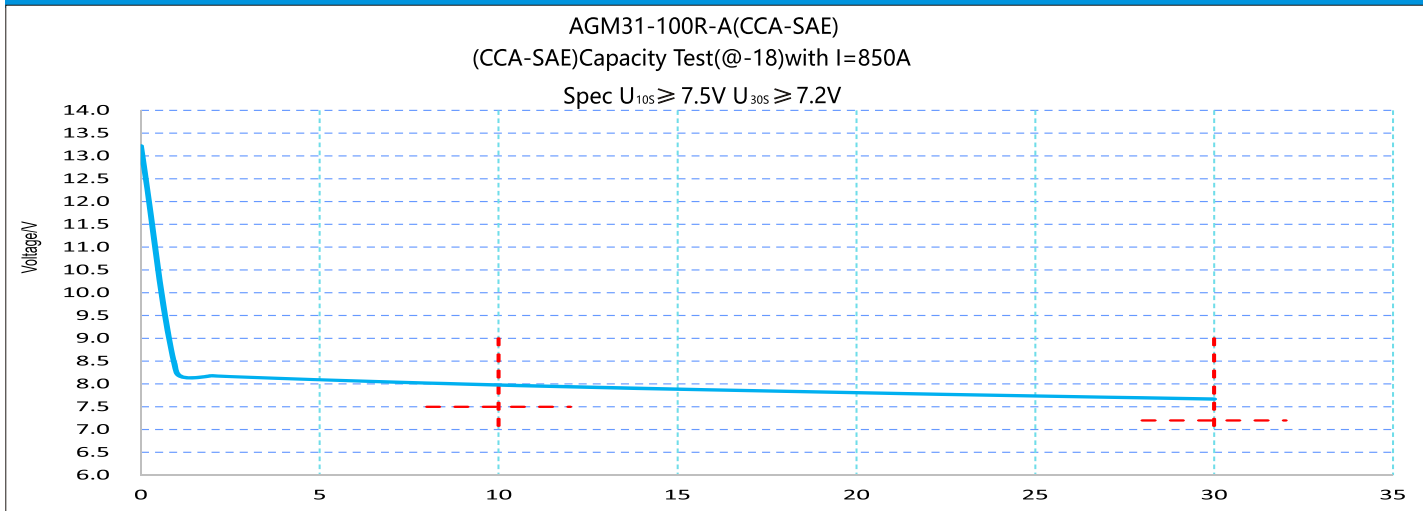

*Values are subject to variation of +/- 5% in normal manufacturing processes.
 *Technical specifications and the product line above could be changed without prior notice.