

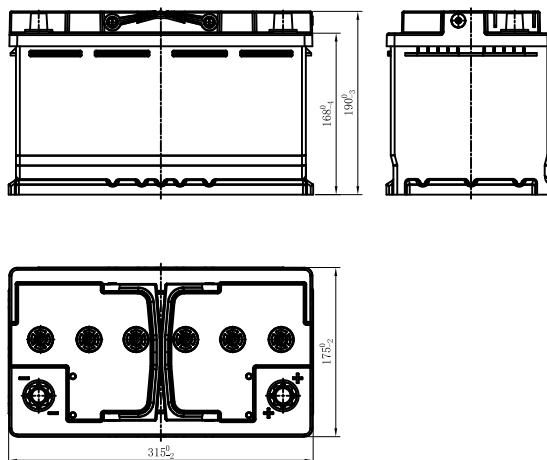

AGM-L4 (12V80Ah)



Dimensions (mm)



Physical Specification (mm)

Nominal Voltage		12V
Nominal Capacity(20HR)		80Ah
Dimension	Length	315 +0/-2mm(12.4inches)
	Width	175 +0/-2mm(6.89inches)
	Container Height	190 +0/-3mm(7.48inches)
	Total Height(with Terminal)	190 +0/-3mm(7.48inches)
Weight		Approx 24.0Kg(52.92lbs)
Standard Terminal		1
Cell layout		0
Hold-Down		B13
Cell plate qty		/
Case		Black-PP Material
Cover		Black-PP Material
Handle		Black-PP Material

Electrical Specification

Rated Capacity	20 hour rate(4.0A)	80A
Reserve Capacity	140min	
Cold Cranking Performance Amps@0°F(-18°C)	800A	

Standard Terminal (mm)

Terminal Type	D	
	Positive	Negative
1	19.5 ⁰ _{-0.3}	17.9 ⁰ _{-0.3}

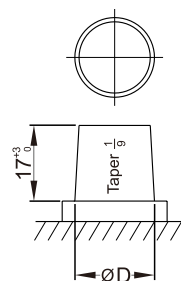

Cell Layout

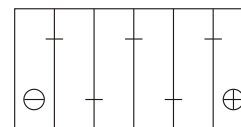

Figure(0)

Discharge Characteristics(-18°C,0°F)

AGM-L4(CCA-SAE)
 (CCA-SAE)Capacity Test(@-18)with I=800A
 Spec $U_{10S} \geq 7.5V$ $U_{30S} \geq 7.2V$

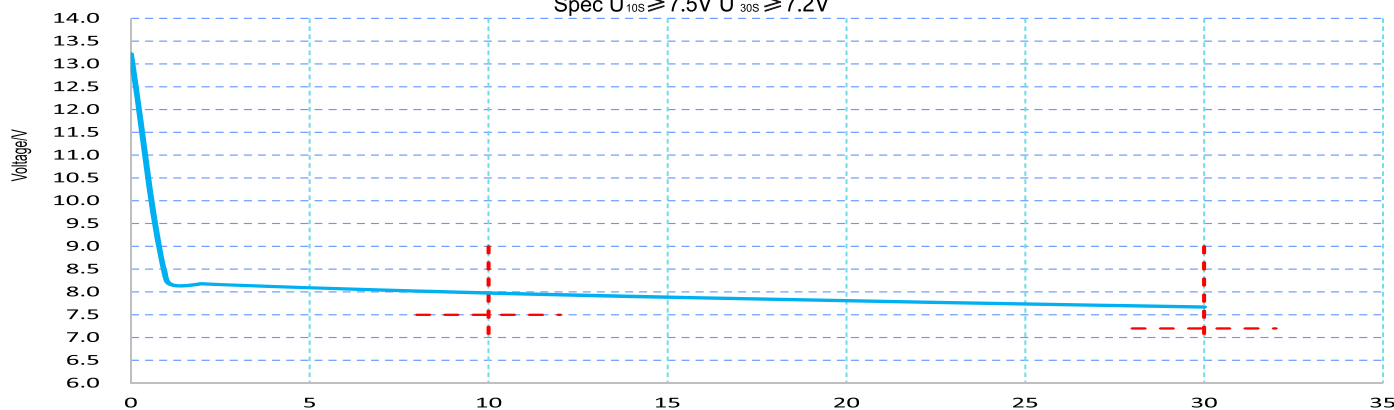

*Values are subject to variation of +/- 5% in normal manufacturing processes.
 *Technical specifications and the product line above could be changed without prior notice.