

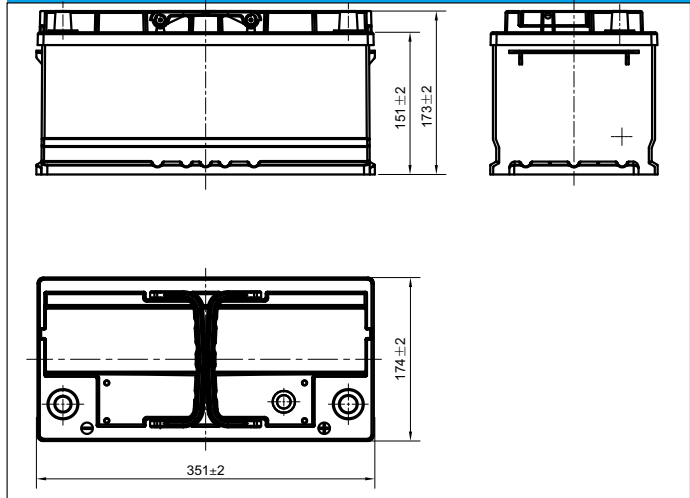

6-QW-72(550)-L (12V72Ah)



Dimensions (mm)



Physical Specification (mm)

Nominal Voltage	12V	
Nominal Capacity(20HR)	72Ah	
Dimension	Length	351±2mm(13.82inches)
	Width	174±2mm(6.85inches)
	Container Height	173±2mm(6.81inches)
	Total Height(with Terminal)	173±2mm(6.81inches)
Weight	Approx19.2Kg(42.2lbs)	
Acid	1.280±0.015g/cm ³ (25°C)	
Standard Terminal	1	
Cell layout	0	
Hold-Down	B13	
Cell plate qty	/	
Case	Black-PP Material	
Cover	Black-PP Material	
Handle	Black-PP Material	
QTY/PLT/layer	/	

Electrical Specification

Rated Capacity	20 hour rate(3.6A)	72Ah
Reserve Capacity	122min	
Cold Cranking Performance Amps@0°F(-18°C)	550A	

Discharge Characteristics(25°C,70°F)

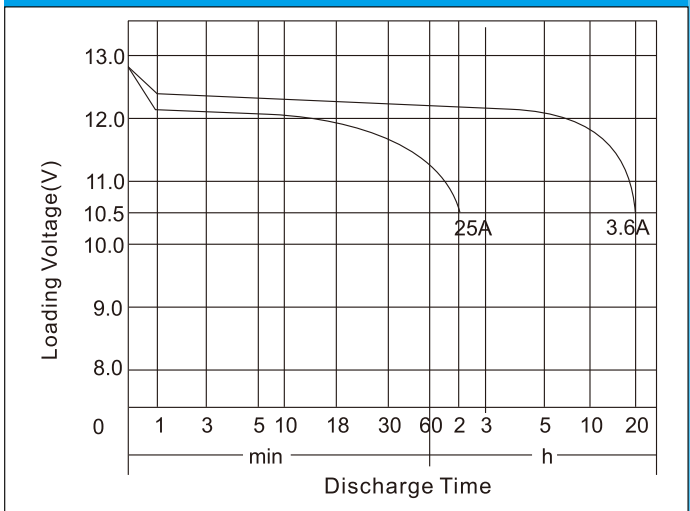

Standard Terminal (mm) Cell Layout

Terminal Type	D		Cell Layout Diagram
	Positive	Negative	
1	19.5 ⁰ _{-0.3}	17.9 ⁰ _{-0.3}	

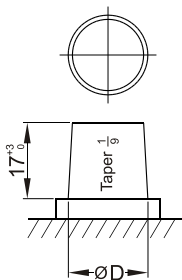

Figure(0)

Discharge Characteristics(-18°C,0°F)

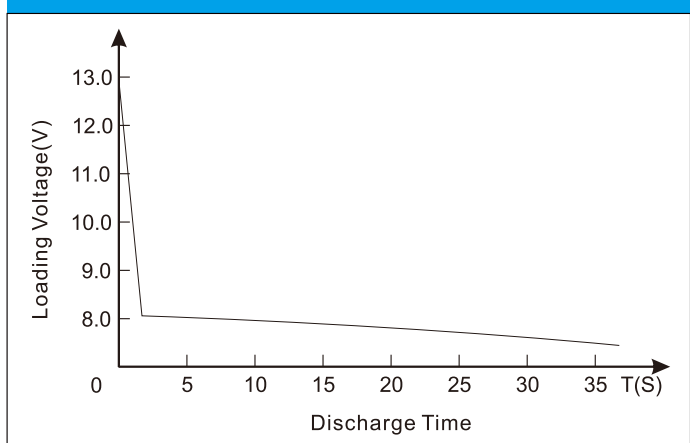

*Values are subject to variation of +/- 5% in normal manufacturing processes.
 *Technical specifications and the product line above could be changed without prior notice.