

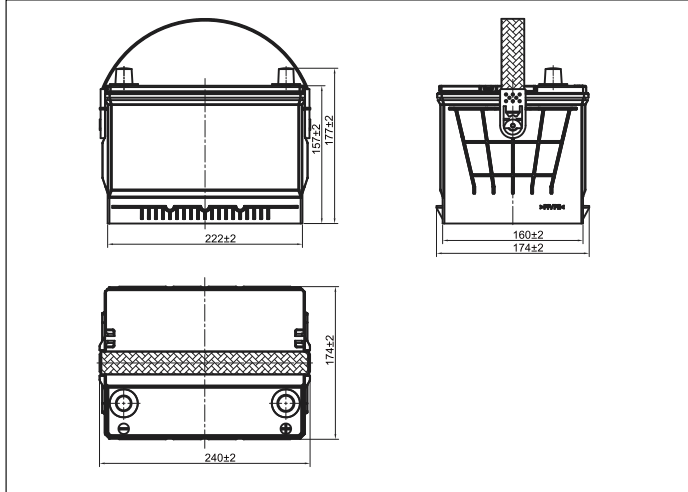

BCI 58R-390 [12V45Ah]



Dimensions (mm)



Physical Specification (mm)

Nominal Voltage		12V
Nominal Capacity(20HR)		45Ah
Dimension	Length	240±2mm(9.45inches)
	Width	174±2mm(6.85inches)
	Container Height	157±2mm(6.18inches)
	Total Height(with Terminal)	177±2mm(6.97inches)
Weight		Approx 12.3Kg(27.2lbs)
Acid		1.280±0.015g/cm ³ (25°C)
Standard Terminal		1
Cell layout		0
Hold-Down		B01
Cell plate qty		/
Case		Black-PP Material
Cover		Black-PP Material
Handle		Black-PP Material
QTY/PLT/layer		/

Electrical Specification

Rated Capacity	20 hour rate(2.25A)	45Ah
Reserve Capacity		70min
Cold Cranking Performance Amps@0°F(-18°C)		390A

Discharge Characteristics(25°C,70°F)

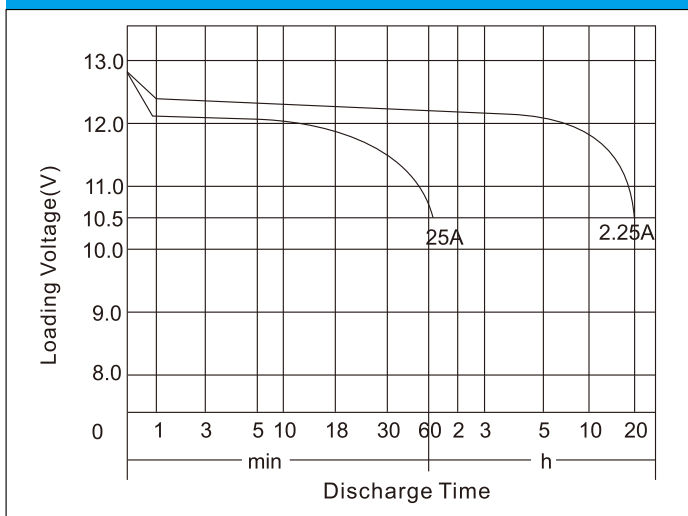

Standard Terminal (mm) Cell Layout

Terminal Type	D		Cell Layout Diagram
	Positive	Negative	
1	19.5 ⁰ _{-0.3}	17.9 ⁰ _{-0.3}	<p>Figure(0)</p>

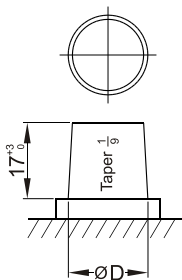

Discharge Characteristics(-18°C,0°F)

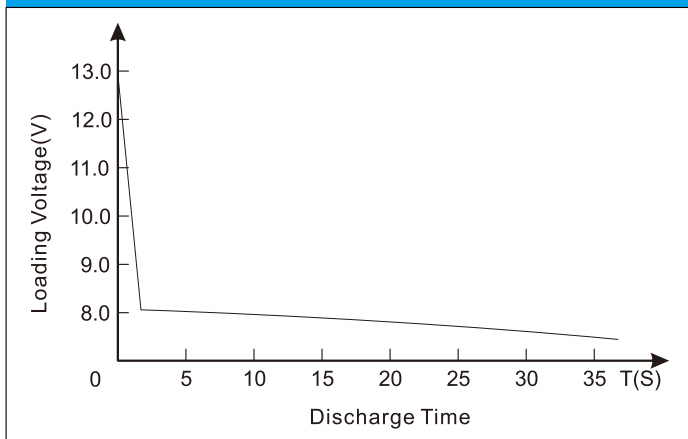

*Values are subject to variation of +/- 5% in normal manufacturing processes.
 *Technical specifications and the product line above could be changed without prior notice.